

CITTÀ

Hem Sofa

Product Information Document

The Hem sofa boasts stylish seating with clean lines and a robust silhouette. The sofa is designed to stand alone or sit with the wider Hem custom-made furniture collection. The collection allows for a myriad of possible combinations across the range of sofas, armchairs, chaise and ottomans. Available with either steel or solid wooden legs. Designed in our New Zealand studio by David Moreland and Nikolai Sorensen and made in your choice of size and fabric.



Hem Sofa

Material: Foam, Dacron, Steel, Plywood

Upholstery: Please refer to "Fabric Specifications PDF" for fabric options.

Leg Height: 20cm
Seat Height: 42.5cm
Arm Height: 63cm

Hem Sofa Configurations

01. 2 Seater

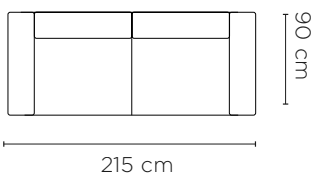

02. 3 Seater



03. Armchair

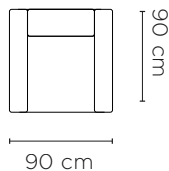

04. Ottoman

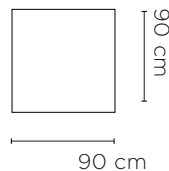

05. Chaise Sofa Left Arm

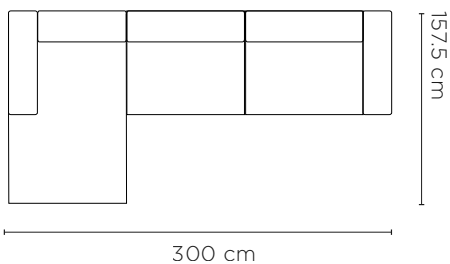

06. Chaise Sofa Right Arm

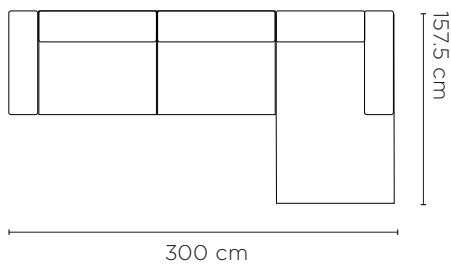

Care Instructions

Avoid direct sunlight. Vacuum regularly using an upholstery attachment on low-suction. All fabric stretches as part of the general wear process. Attend to spills immediately by soaking them up with a clean, absorbent, lint-free sponge or cloth. Gently dab; do not rub vigorously. If cleaning products are required, consult a furniture cleaning specialist. We do not recommend using any fabric protector treatments, as this voids your fabric warranty. Please note, all fabric warranties are with the fabric supplier. Città sofas have a 5-year warranty that covers the frame and fill.

Residential Warranty

Upholstery: 1 Year | **Frame:** 10 Years

Commercial Warranty

Upholstery: 1 Year | **Frame:** 5 Years

Scatter Cushion Options

Sold Separately (Single)

- 01. 55 x 55 cm
- 02. 60 x 30 cm
- 03. 60 x 40 cm
- 04. 70 x 45 cm

Hem Component Assembly

The Hem sofa is connected using a locking system located on the base of each component. Locking components prevents parts of the sofa from moving around independently.

Lock Disconnected

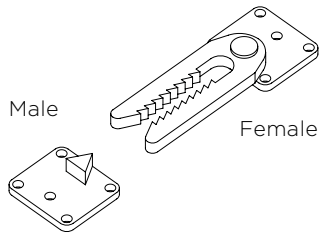

Lock Connected

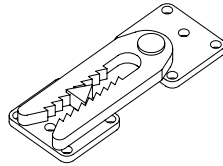

Step 1

To connect two components, place each unit side by side aligning the male and female part of the lock.

Each component has two male locks and two female locks on opposite sides of the sofa base.

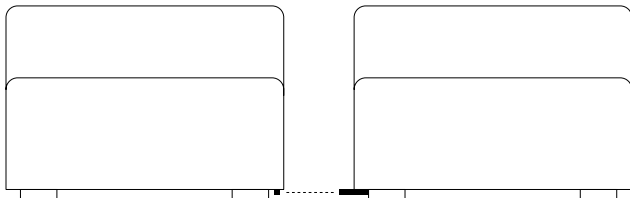

Front View.

Step 2

Push units together engaging the locking system.

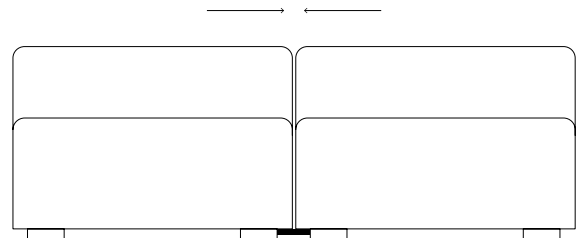

Front View.

Step 3

To separate units, lift up the male part out from female part.

Note: Do not drag the components away from each other to separate.

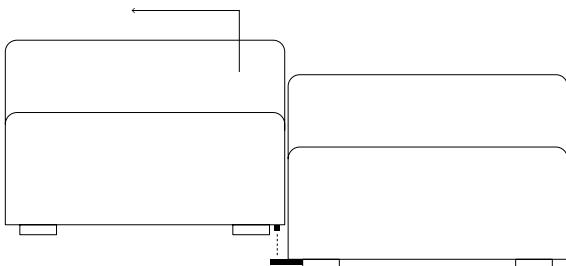

Front View.

Pricing Guide

Low _____ Fabric Price Categories _____ High

A	B	C	D	E
James Dunlop - Entwine	Warwick - Theodora	James Dunlop - Rough	James Dunlop - Alpaca Velvet	Kvadrat - Coda 2
James Dunlop - Bora Bora	Warwick - Axiom	Kvadrat - Savanna	Kvadrat - Ecriture	
Nube - Stof Nandina	James Dunlop - Prato	Kvadrat - Keiga	Kvadrat - Zero	
Nube - Stof Flax	James Dunlop - Como	Camira - Mainline Flax	Kvadrat - Moss	
		Camira - Synergy	Kvadrat - Cifrado	
		Città - Winton	Kvadrat - Mosaic 2	
			Kvadrat - Clay	

Hem Sofa

	A	B	C	D	E
Hem 2 Seater	\$4,430.00	\$4,990.00	\$5,210.00	\$5,800.00	\$6,470.00
Hem 3 Seater	\$5,480.00	\$6,080.00	\$6,320.00	\$6,960.00	\$7,680.00
Hem Armchair	\$2,790.00	\$3,110.00	\$3,230.00	\$3,570.00	\$3,950.00
Hem Ottoman	\$1,760.00	\$1,900.00	\$1,960.00	\$2,110.00	\$2,280.00
Hem w/ Chaise Left Arm	\$8,580.00	\$9,490.00	\$9,860.00	\$10,830.00	\$11,930.00
Hem w/ Chaise Right Arm	\$8,580.00	\$9,490.00	\$9,860.00	\$10,830.00	\$11,930.00

Scatter Cushions

	A	B	C	D	E
55 x 55cm	\$90.00	\$150.00	\$170.00	\$220.00	\$290.00
60 x 30cm	\$90.00	\$140.00	\$160.00	\$220.00	\$280.00
60 x 40cm	\$120.00	\$200.00	\$230.00	\$310.00	\$400.00
70 x 45cm	\$130.00	\$200.00	\$230.00	\$310.00	\$400.00